



ARAPATI BEACH BACH

RAROTONGA

Arapati Beach Bach located on the south coast of Rarotonga in Vaimaanga, was built in 2008 and is only a few minutes walk from a nearby Supermarket as well as two very popular restaurants.

This two storey, two bedroom self contained property has an open plan outdoor living and dining area under cover on a split level balcony with a BBQ area and a day bed for lounging and enjoying the cool summer breeze.

Wake up to the beautiful views of the Titikaveka lagoon as well as on-looking the reef and into the ocean - from your bedroom window or as you laze away on the balcony watching the beautiful sun rise over the sea.

The main bedroom features one splitable king bed and a single sofa fold out bed with a walk in wardrobe, ceiling fan, an ensuite bathroom and laundry room. Completed as well with it's own entertainment devices such as a TV, DVD player and CD/Radio, just to keep you occupied.

This Beach Bach can either be sold as a one bedroom or two bedroom house for families, as conveniently located downstairs is the guestroom, which features a king size bed, a set of outdoor chairs, an ensuite bathroom and laundry facilities.

Arapati Beach Bach is in one of the quietest parts of Rarotonga with the cleanest and least populated white sandy beach perfect for swimming and snorkelling.



Arapati Beach Bach awaits you



Simple & fully equipped kitchen area



Dining Area

TOP FEATURES

Location

Great private beachfront area with only a few metres from the waters edge. The house itself also has a nice indoor/outdoor flow given its location right next to the beach.

Close Proximity

Arapati Beach Bach is conveniently located near a mini supermarket known as Wigmore's Super Store, and also a few popular restaurants within the Vaima'anga district, you wont be disappointed.

CHILD POLICY

Children are welcome



Your spacious outdoor relaxing area...

ROOM CONFIGURATION & LAYOUT

ROOM CATEGORIES	TOTAL ROOMS	BEDDING CONFIGURATION	MAX PAX
1 BEDROOM BEACH HOUSE	1	1 X KING BED + SOFA BED	2
GUESTROOM	1	1 X SPLITABLE KING BED	2

PROPERTY LAYOUT

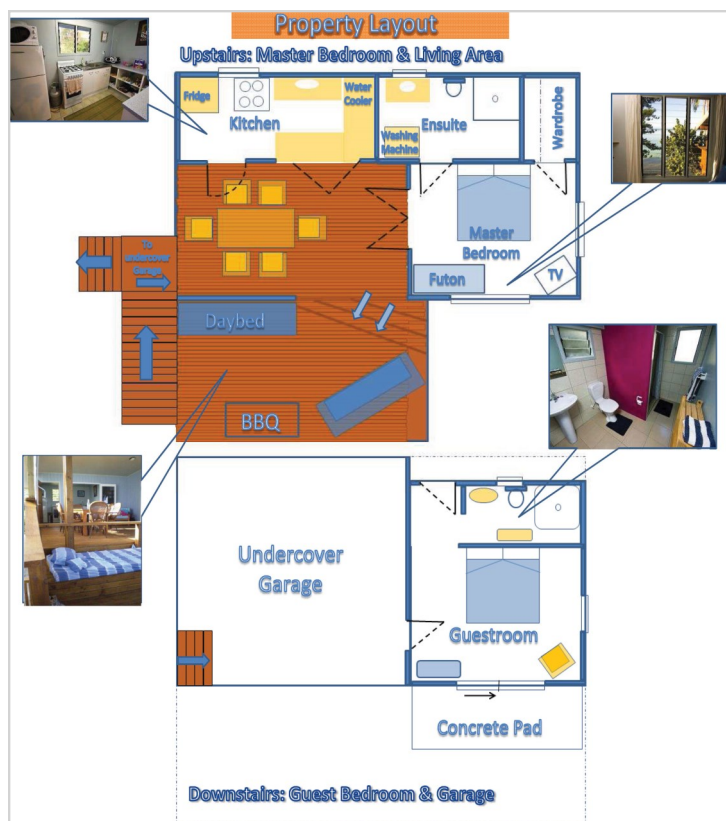

The property is sold either as a One Bedroom or Two bedroom Beach House.



Upstairs Master Bedroom: Overlooking the water, the bedroom opens out onto the entertainment deck.



Downstairs Guestroom: Opens out onto the beach and accessible from the undercover garage.

ROOM FACILITIES

	IN ROOM
AIR CONDITIONING	X
BATH IN ROOM (SPA)	X
CEILING FAN	✓
DVD PLAYER	IN THE MAIN ROOM
FIRE EXTINGUISHERS	X
FULL OCEAN VIEW	✓
HAIRDRYER	✓
INTERNET CONNECTION	X
KITCHEN	✓
LUGGAGE STORAGE	✓
MICROWAVE	✓
RADIO/ALARM CLOCK	✓
REFRIGERATOR	✓
ROOM SERVICED	X
SAFE IN ROOM	✓
SHOWER	✓
GAS OVEN	✓
SURROUND SOUND SYSTEM	X
TEA/COFFEE FACILITIES	✓
TELEPHONE IN ROOM	✓
TOILET IN ROOM	✓
TV/DVD SYSTEM	✓

PROPERTY FACILITIES

	ON SITE
BABY SITTING FACILITIES	X
BBQ FACILITIES	✓
BEACH ON SITE	✓
BICYCLES	X
BEAUTY/HEALTH SERVICES	X
FULL OCEAN VIEW	✓
GARDEN VIEW	X
GUESTROOM (DOWNSTAIRS)	✓
INTERNET CONNECTION	X
KAYAKS/CANOES	✓
LAUNDRY SERVICE/FACILITY	✓
RESTAURANT/BAR	NEARBY
SAFETY DEPOSIT BOX	✓
SHOP	NEARBY
SNORKELLING GEAR	✓
SWIM ALL TIDES	✓
SWIM SOME TIDES	X
SWIMMING POOL	X
TOUR DESK	X
VEHICLE RENTAL	CHECK FOR ARRANGEMENT
WAITING LOUNGE	X
WEDDING CO-ORDINATOR	X

UPDATED NOVEMBER 2016

PROPERTY LOCATION



PROXIMITY TO	DRIVE / WALK TIME
AIRPORT	20 MINS DRIVE
AVARUA TOWNSHIP	25 MINS DRIVE
RESTAURANTS - YELLOW HIBISCUS - VAIMA RESTAURANT - SAILS RESTAURANT	2 MINS WALK 2 MINS WALK 10 MINS WALK
CLOSEST RESORT	PACIFIC RESORT – 10 MINS
GROCERY STORES	2 MINS WALK